

GEORGE B. DUPONT P.L.S.					
SURVEY AND PLOT PLAN					
DRAWN BY STEPHEN WILDENHAIN	APPROVED BY	APPROVED DATE	DATE 1/6/22	SCALE 1' = 30' -0"	
109 COLUMBIA STREET SOUTH KINGSTOWN, RI ASSESSORS PLAT 57-1 LOT 201		OWNER		EDITION 1	SHEET 1 OF 1

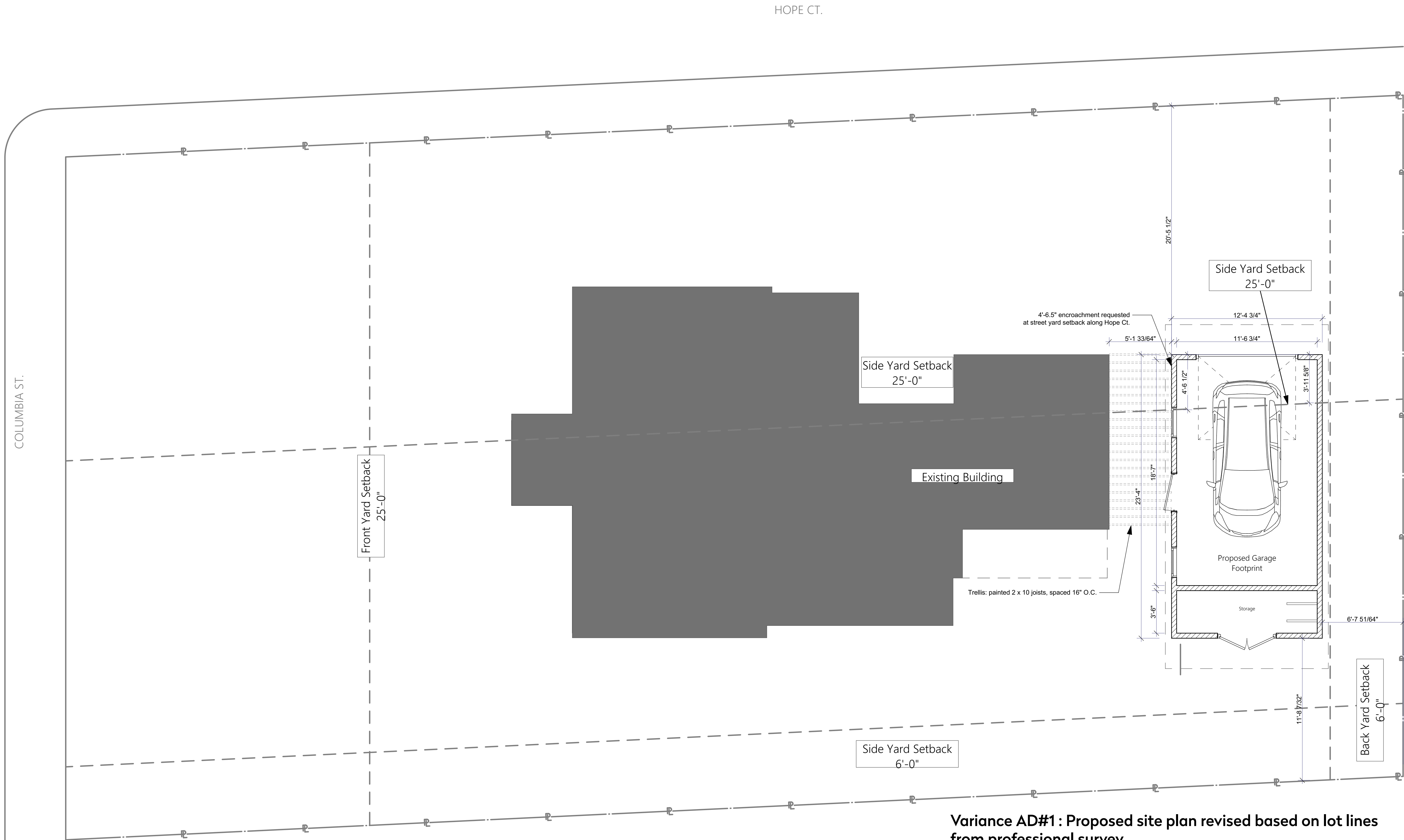

Variance AD#1 : Proposed site plan revised based on lot lines from professional survey.

Intent: Rear yard lot line closer to existing home than originally anticipated. In an effort to maintain the relief already requested, the proposed detached garage's footprint has been revised to be thinner and longer to avoid encroachment into the required 6' rear yard setback. No increase in relief is being requested.